

SCATOLARE S25-T1
L=26mt If=0.002 Dz=0.05

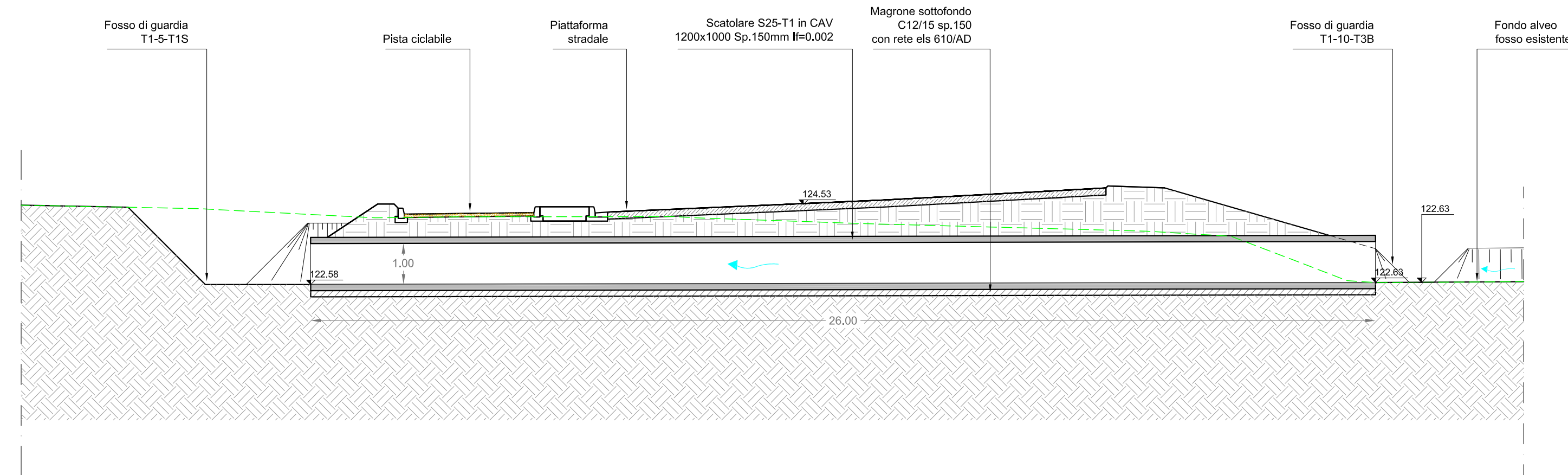

Canale S19-Es
L52m If=0.01

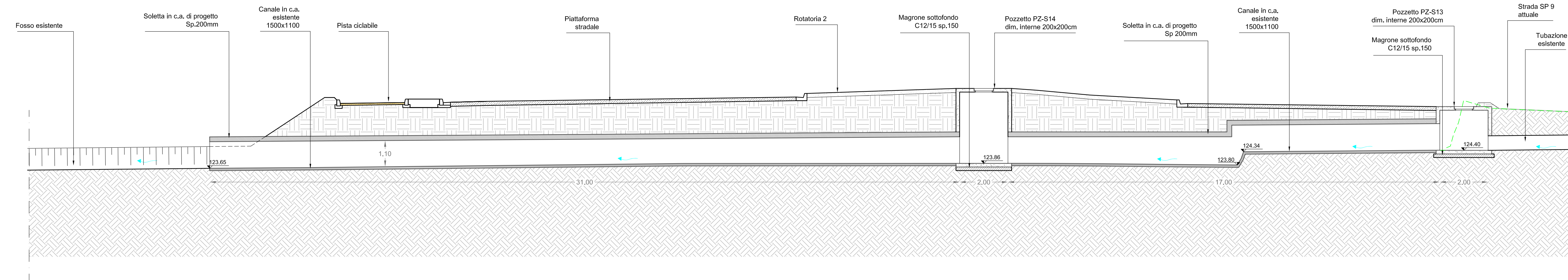

SCATOLARE S13-T4
L=22mt If=0.01 Dz=0.22

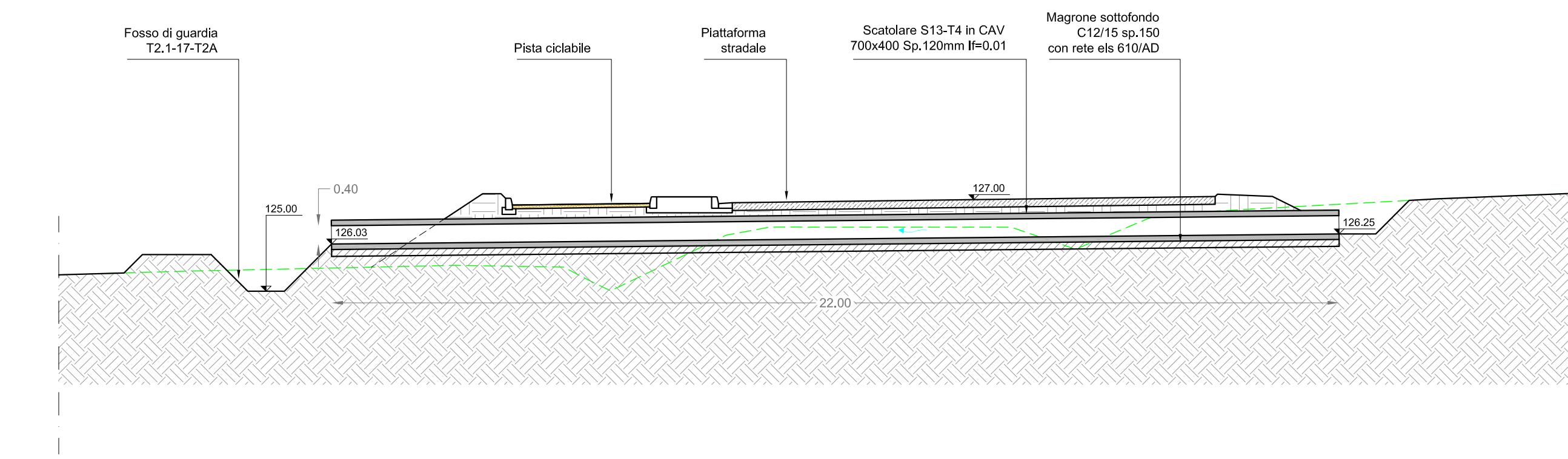

SCATOLARE S9-T3
L=26mt If=0.01 Dz=0.26

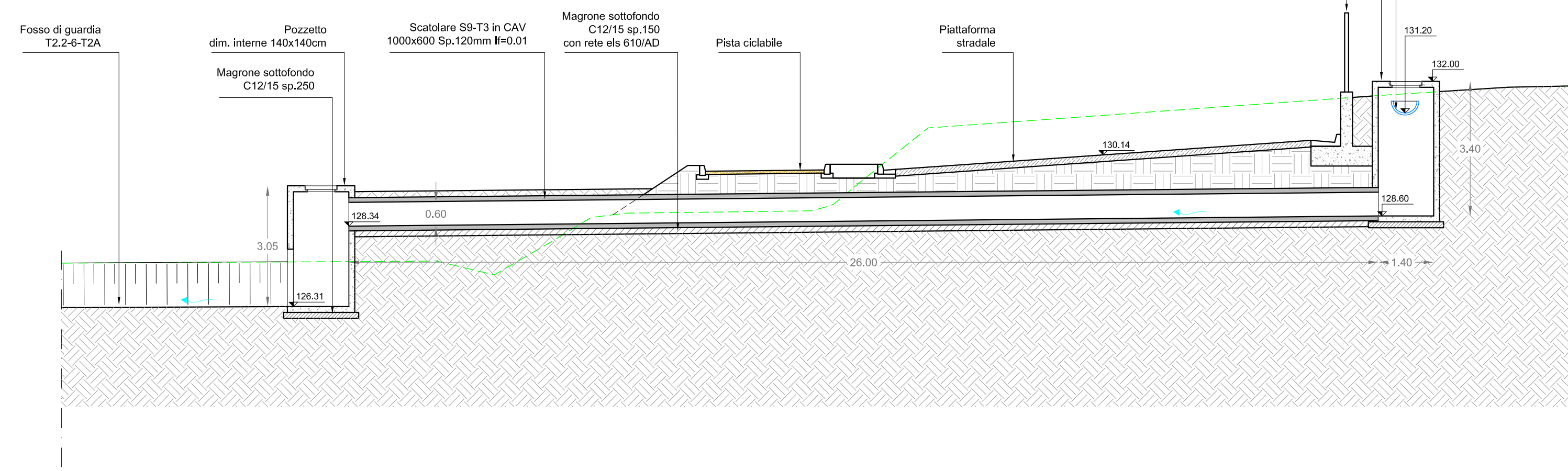

SCATOLARE S7-T2
L=30mt If=0.005 Dz=0.15

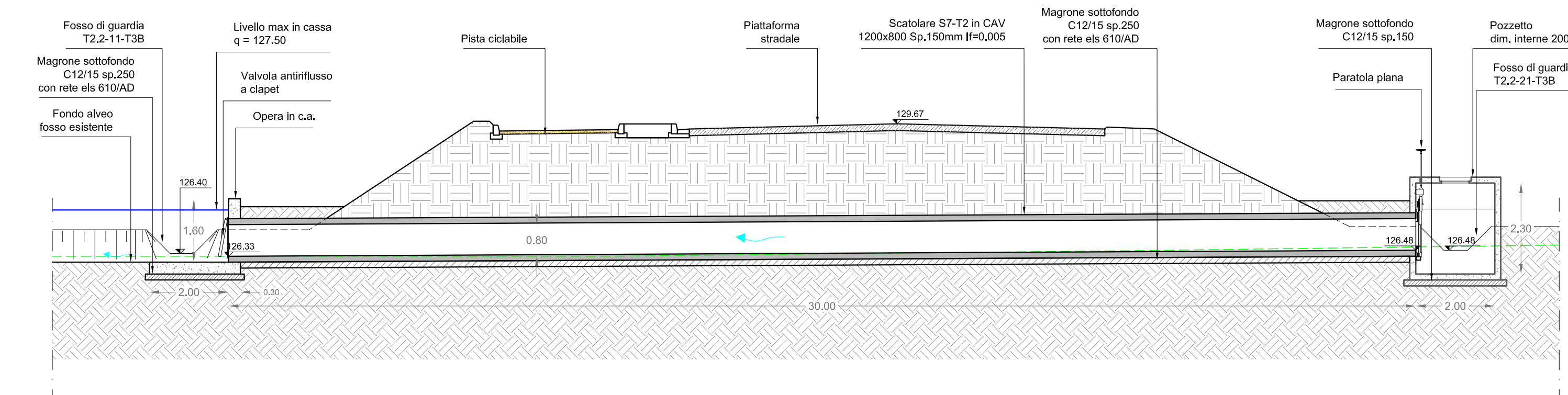

SCATOLARE S3-T2
L=24mt If=0.002 Dz=0.05

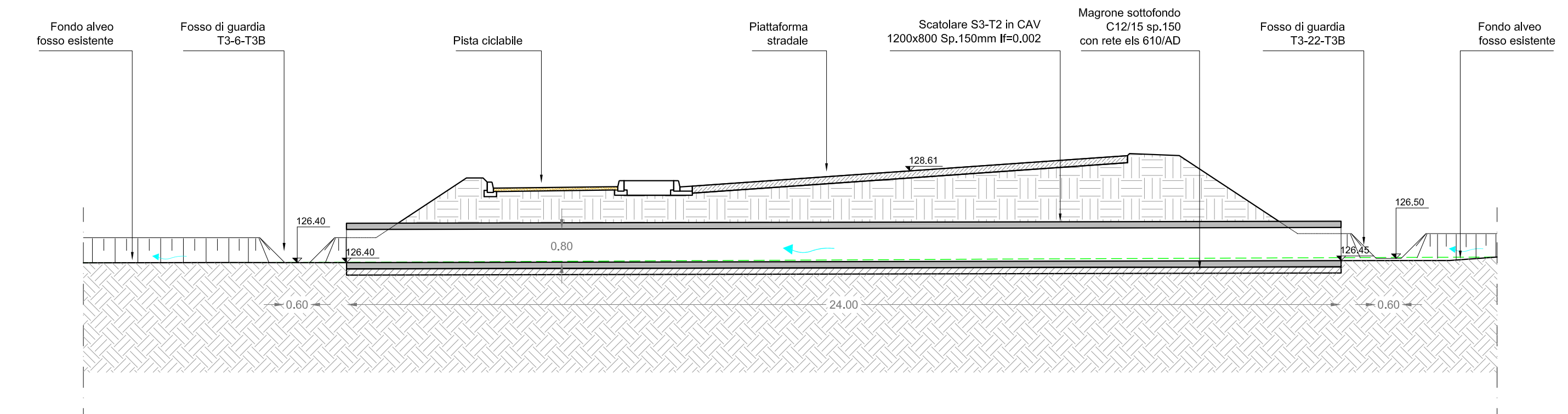

S.R. n° 69 "Di Val d'Arno"
Variante in riva destra d'Arno
LOTTO 5

Provincia di Firenze e Arezzo
Comune di Figline e Incisa Valdarno, Castelfranco
Piandiscò e San Giovanni Valdarno



PROGETTO DEFINITIVO

Attraversamenti Minori - Sezioni Tipologiche

NOME FILE: D-C-13_11_Atraversamenti Minori-Sez Tipologiche_R1
C.U.P. D3181000053002
R.U.P.: Ing. Antonio De Crescenzo
Data revisione elaborato: Luglio 2021

PROGETTISTA:
Ing. Alessio Gensini
PROGETTISTI OPERE IDRAULICHE:
SORGENTE INGEGNERIA
STUDIO TECNICO INGEGNERIA AMBIENTALE
Ing. Luca Rosadini
Ing. Leonardo Marini

SETTORE PROGETTAZIONE E REALIZZAZIONE VIABILITA' REGIONALE
FIRENZE - PRATO - PISTOIA